

9363 UNIVERSAL LOAD CELL



DESCRIPTION:

The 9363 is a true multi-purpose stainless steel S-type load cell which can be used in tension or compression.

This product is suitable for a wide range of hybrid scales, overhead track scales, belt scales and process weighing applications.

Reliable sealing is ensured by the proprietary TRANSEAL potting compound and additional mechanical protection of the strain gauge area.

This product meets the stringent Weights and Measures requirements throughout Europe.

FEATURES:

- # Stainless steel construction
- # Certified to OIML R60, **3000d**
- # Suitable for compression and tension applications
- # Trimmed output versions available
- # **CAPACITIES: 50 6 10000 kg**
(100 6 20 K lbs also available)

9363: SPECIFICATIONS:

Standard Capacities (= E _{max})	kg	50 ³ , 100 ³ , 250, 500, 1000, 2500, 5000, 7500, 10000 ²			
Standard Capacities (= E _{max})	lbs	100 ³ , 200 ³ , 300, 500, 750, 1K, 1.5K, 2K, 3K, 5K, 10K, 15K, 20K ²			
Accuracy Class According to OIML R-60			C1	C2	C3
Max. Number of Verification Intervals (n _v)			1000	2000	3000
Minimum Verification Interval (V _{min})			E _{max} /4500	E _{max} /6000	E _{max} /9000
Minimum Utilisation			25	33	33
Accuracy According to Type Designation		CC	C1	C2	C3
Combined Error	%S	#'' 0.0500	#'' 0.0300	#'' 0.0230	#'' 0.0200
Non-Repeatability	%S	#'' 0.0200	#'' 0.0200	#'' 0.0100	#'' 0.0100
Minimum Dead Load Output Return ¹	%S	#'' 0.0500	#'' 0.0500	#'' 0.0250	#'' 0.0167
Creep Error (30 Minutes) ¹	%S	#'' 0.0600	#'' 0.0490	#'' 0.0245	#'' 0.0245
Creep Error (20-30 Minutes) ¹	%S	#'' 0.0200	#'' 0.0105	#'' 0.0053	#'' 0.0053
Temp. Effect on Min. Dead Load Output	%S/5EC	#'' 0.0250	#'' 0.0140	#'' 0.0112	#'' 0.0070
Temp. Effect on Sensitivity	%S/5EC	#'' 0.0250	#'' 0.0085	#'' 0.0060	#'' 0.0050
Minimum Dead Load	%E _{max}	0			
Maximum Safe Overload	%E _{max}	150			
Ultimate Overload	%E _{max}	250			
Maximum Safe Sideload	%E _{max}	100			
Excitation Voltage	V	5...12			
Maximum Excitation Voltage	V	15			
Rated Output (= S)	mV/V	3.3			
Tolerance on Rated Output	mV/V	" 0.3			
Rated Output (Trimmed Version)	mV/V	3			
Tolerance on Rated Output (Trimmed Version)	mV/V	" 0.0075			
Zero Balance	%S	#'' 1.0			
Input Resistance	Ω	390 " 15			
Input resistance (Trimmed version)	Ω	430 " 60			
Output Resistance	Ω	350 " 3.5			
Insulation Resistance	MΩ	\$ 5000			
Compensated Temperature Range	EC	-10...+ 40			
Operating Temperature Range	EC	-40...+ 80			
Storage Temperature Range	EC	-40...+ 90			
Element Material (DIN)		Stainless Steel 1.4542			
Sealing (DIN 40.050)		IP67			

- 1 Applies for the temperature range -10 to + 40 EC
 2 CC accuracy only
 3 Non-Humidity load cell (OIML R60, 5.5.3.1 not applicable)

Correct mounting of the load cells is essential to ensure optimum performance. Cable length 6m. Cable screen is not connected to load cell body. Performance may be affected if load cell cables are shortened. Multiple loadcell applications require trimmed versions of the 9363 type loadcell for accurate parallel connection. Further information is available on request.

REVERE TRANSDUCERS EUROPE B.V.

Ramshoorn 7
 Postbus 6909, 4802 HX Breda
 The Netherlands
 Tel: (+ 31) 76-5480700
 Fax: (+ 31) 76-5412854

REVERE TRANSDUCERS INC.

14192 Franklin Ave
 Tustin, CA 92780-7016
 U.S.A.
 Tel: 714.731.1234
 Fax: 714.731.2019

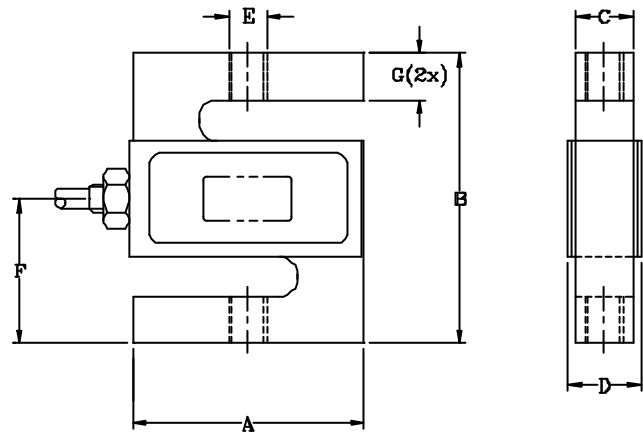

E _{max} Kg	50,100	250,500	1000	2500	5000	7500	10000
E _{max} Lbs	100,200,300	500-1.5K	2K, 2.5K	3K*, 5K	10K	15K	20K
A	50.8	50.8	50.8	76.2	74.7	87.4	112.8
B	61.0	61.0	61.0	99.1	99.1	139.7	177.8
C	11.7	18.0	24.4	24.4	30.7	37.1	42.9
D max.	16.5	22.9	29.2	29.2	35.6	41.4	47.8
E (kg)	M8x1.25-6H	M12x1.75-6H	M20x1.5-6H	M24x2-6H	M30x2-6H		
E (Lbs)	1/4-28 UNF-2B	1/2-20 UNF-2B	3/4-16 UNF-2B	1-14 UNF-2B	1 1/4-12 UNF-2B		
F	30.5	30.5	30.5	49.5	49.3	69.9	88.9
G	8.9	8.9	8.9	14.0	15.7	22.4	31.8

* Note: 3 Klbs version has 1/2-20 UNF-2B thread

Wiring:

Excitation + Red
 Excitation - Black
 Output + Green
 Output - White
 Shield Orange

Attention:

All dimensions: mm.
 All dimension tolerances according to DIN 7168; middle accuracy unless otherwise specified.

All specifications subject to change without notice

REGIONAL OFFICE UK

The Business Centre
 Edward Street, Redditch
 Worcs B97 6HA, UK
 Tel: (+ 44) 1527-65888
 Fax: (+ 44) 1527-64888